

Cync Fan Speed Switch (Neutral Required) Specifications



Box Contents



- (1) Faceplate
- (4) Wire Nuts
- (4) Screws
- (1) Installation Guide
- (1) Quick Start Guide
- (1) Wire Label Sticker Set

Specifications

Device

Description	CPLGSTDBLW1
Capability	On/Off, Speed Up/Down
Finish	White
Indicators	Light Ring LED (RGBW); Speed Display LEDs (4 white)
Buttons	3

Dimensions and Weight

	Length	Width	Height	Weight
Switch Back Housing (LxWxH)	2.6in (66mm)	1.75in (44.5mm)	1.18in (30mm)	
Overall Switch Unit (LxWxH)	4.13in (105mm)	1.75in (44.5mm)	1.61in (41mm)	0.35lbs (160g)
Faceplate (LxWxH)	4.6in (118mm)	2.9in (74mm)	0.28in (7mm)	

Electrical

Input Voltage	120V, 60Hz
Max Load	1.5 A
Wires	4
Wire Type	Line, Neutral, Load, Ground
Neutral Required	Yes
Ground Required	Yes

Environmental

Ambient Temperature	32°F to 104°F (0°C to 40°C)
Operating Temperature	32°F to 104°F (0°C to 40°C)
Storage Temperature	-4°F to 140°F (-20°C to 60°C)
Relative Humidity	< 88% 32°C
Environment (Wet, Dry, Damp)	Dry
IP Rating	IP20

Controls

On/Off Button	Press center button to turn on/off the load (fan).
Speed Up/Down	Press top button to increase fan speed, press button bottom to decrease fan speed.
Mobile Compatibility	Works with iOS 13 and above and Android 9 and above
Voice Control Commands	Works with Google Home and Amazon Alexa

Wireless Standards

Wireless	Yes
Wireless Protocol	Wi-Fi (2.4 GHz) and BLE
Local Control	Local Control via BLE
Out-of-Home Control	Out-of-Home Control via OTA (Over The Air)
Wi-Fi Range	30m (open area)

LED Behavior

	LED	Function	LED Color	Interval
Commissioned	Light Ring	Factory Reset	Red	Static
	Light Ring	Wi-Fi Disconnected	Red	Static
Uncommissioned	Light Ring	Factory Reset	Red	Static
	Light Ring	Identify	Green	Blink
	Light Ring	Wi-Fi Connected	Blue	Static
	Light Ring	Setup Mode	Blue	Blink

Reliability and Warranty

Warranty	2 Year Limited		
Warranty Operating Conditions	Operating Voltage	120V, 60Hz	
	Operating Temperature	32°F to 104°F (0°C to 40°C)	
	Operating Humidity	RH < 88% 32°C	

Certifications

Safety Listing	UL60730-1
FCC	Complies with FCC Part 15, Class B

Device Overview

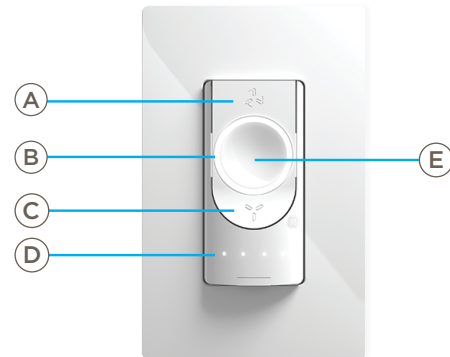

- (A) Increase Fan Speed Button
- (B) Light Ring
- (C) Decrease Fan Speed Button
- (D) LED Fan Speed Indicator
- (E) Center Button - On/Off

Compatibility

Multi-location control is possible with two or more Cync Switches within a single App room via Bluetooth. Cync Fan Switches are compatible with pull chain ceiling fans without electronic control by setting the fan to the highest fan speed setting via the pull chain, and using the Cync Speed Fan Switch to set the desired the fan speed.

Cync Speed Fan Switches will not work with traditional "non-smart" switches. Not to be used to control DC motor fans, fans with integrated fan speed or light control modules, fans with remote controls, or bathroom and kitchen exhaust fan types.

For more information on wiring compatibility please view the [Fan Speed Compatibility \(Neutral Required\) & Wiring Configurations](#) guide.